



CLADDING



COLORS



from
\$5,355

Stud Frame Garage

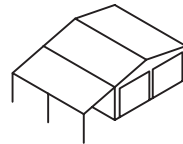

LEAN-TO



GARAPORT

INCLUDED

- ✓ Region: A Importance Level: 1 Terrain category: 2
- ✓ Gutters & Downpipes
- ✓ 2 Front Roller Doors
- ✓ Made of Ultraframe® Stud Frame
- ✓ Trim 1000 or Corry 1000 cladding
- ✓ In Full Colour

OPTIONS

- PA Door
- Window
- Side Roller Door
- Glass Sliding Door
- Insulation
- Skylight
- Roller Door Drive

“ULTRAFRAME”[®] Stronger, faster

“ULTRAFRAME”[®], our unique frame system, is made from Rectangular Hollow Section (RHS) structural steel or universal beam and web truss for larger spans. All brackets, cleats and joiners are welded to the “ULTRAFRAME”[®]. Simple rapid construction.

*Simply bolt your columns and rafters together and your frame is ready to add purlins!!!
No Apex or Knee braces required.*

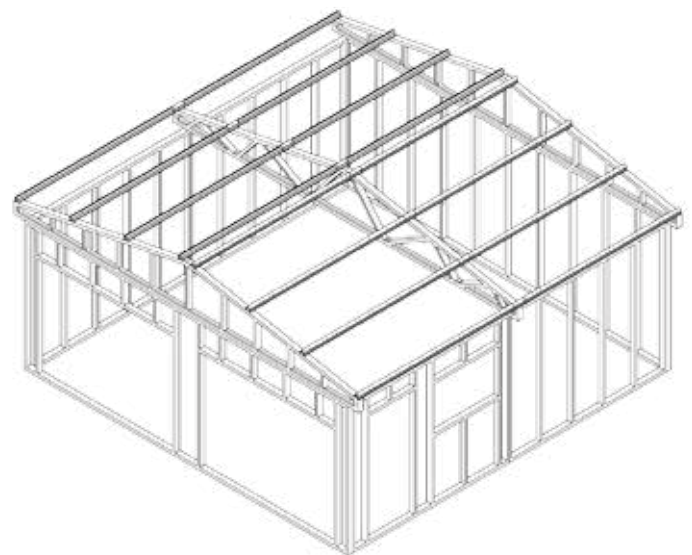

Stud Frame Garage

Part No	Width	Length	Height	Roof Pitch	Door Opening W.H	Supply	Concrete	Construct
DG60602411	6m	6m	2.4m	11°	2 @ 2.5 x 2.1m	\$5,355
DG60602711	6m	6m	2.7m	11°	2 @ 2.5 x 2.4m	\$5,668
DG60603011	6m	6m	3.0m	11°	2 @ 2.5 x 2.7m	\$5,999
DG60802411	6m	8m	2.4m	11°	2 @ 2.5 x 2.1m	\$5,712
DG60802711	6m	8m	2.7m	11°	2 @ 2.5 x 2.4m	\$6,292
DG60803011	6m	8m	3.0m	11°	2 @ 2.5 x 2.7m	\$6,639
DG60902411	6m	9m	2.4m	11°	2 @ 2.5 x 2.1m	\$6,985
DG60902711	6m	9m	2.7m	11°	2 @ 2.5 x 2.4m	\$7,373
DG60903011	6m	9m	3.0m	11°	2 @ 2.5 x 2.7m	\$7,744
DG60122411	6m	12m	2.4m	11°	2 @ 2.5 x 2.1m	\$7,876
DG60122711	6m	12m	2.7m	11°	2 @ 2.5 x 2.4m	\$8,319
DG60123011	6m	12m	3.0m	11°	2 @ 2.5 x 2.7m	\$8,723
DG60162411	6m	16m	2.4m	11°	2 @ 2.5 x 2.1m	\$9,459
DG60162711	6m	16m	2.7m	11°	2 @ 2.5 x 2.4m	\$9,956
DG60163011	6m	16m	3.0m	11°	2 @ 2.5 x 2.7m	\$10,413
DG75802711	7.5m	8m	2.7m	11°	2 @ 2.5 x 2.4m	\$7,981
DG75803011	7.5m	8m	3.0m	11°	2 @ 2.5 x 2.7m	\$8,337
DG75803611	7.5m	8m	3.6m	11°	2 @ 2.5 x 3.0m	\$9,234
DG75902711	7.5m	9m	2.7m	11°	2 @ 2.5 x 2.4m	\$8,612
DG75903011	7.5m	9m	3.0m	11°	2 @ 2.5 x 2.7m	\$8,994
DG75903611	7.5m	9m	3.6m	11°	2 @ 2.5 x 3.0m	\$9,942
DG75122711	7.5m	12m	2.7m	11°	2 @ 2.5 x 2.4m	\$9,991
DG75123011	7.5m	12m	3.0m	11°	2 @ 2.5 x 2.7m	\$10,405
DG75123611	7.5m	12m	3.6m	11°	2 @ 2.5 x 3.0m	\$11,425
DG75162711	7.5m	16m	2.7m	11°	2 @ 2.5 x 2.4m	\$12,004
DG75163011	7.5m	16m	3.0m	11°	2 @ 2.5 x 2.7m	\$12,477
DG75163611	7.5m	16m	3.6m	11°	2 @ 2.5 x 3.0m	\$13,767

*Supply Prices are Ex Shed Makers Factory and include GST

*Concrete price & Construct price are estimate and must be confirmed on site inspection

*Prices include GST

Notes

<p>Choose your color:</p> <ul style="list-style-type: none"> <input type="checkbox"/> Cream <input type="checkbox"/> Almond <input type="checkbox"/> Pearl White <input type="checkbox"/> Aluzinc <input type="checkbox"/> Eucalypt Green <input type="checkbox"/> Heritage Green <input type="checkbox"/> Woodland <input type="checkbox"/> Ocean Blue 	<p>Cladding:</p> <ul style="list-style-type: none"> <input type="checkbox"/> Corry 1000 <input type="checkbox"/> Trim 1000 	<p>Options</p> <p><i>We can also supply you:</i></p> <ul style="list-style-type: none"> <input type="checkbox"/> PA Door \$ _____ <input type="checkbox"/> Window \$ _____ <input type="checkbox"/> Side Roller Door \$ _____ <input type="checkbox"/> Glass Sliding Door \$ _____ <input type="checkbox"/> Insulation \$ _____ <input type="checkbox"/> Skylight \$ _____ <input type="checkbox"/> Roller Door Drive \$ _____
--	---	--

PRICED FROM \$

(Region: Terrain: Level:)

CUSTOMER

NAME _____

EMAIL _____

TEL _____ FAX _____

POSTAL ADDRESS _____

SITE ADDRESS _____